

## PA-13 Data Sheet



### Contents

Specifications	2
Dimensions	3
Speed/Current vs Load	4
Connectors & Feedback	5

# Specifications



Load (LBS)		No Load Current (A)				Full Load Current (A)				Speed (inch/sec)	
Dynamic	Static	12VDC	24VDC	36VDC	48VDC	12VDC	24VDC	36VDC	48VDC	No Load	Full Load
3000	3500	4.0	2.4	1.8	1.2	20.0	10.5	7.5	5.3	0.25	0.17

<b>Stroke</b>	0.79" to 40"
<b>Limit Switch</b>	Internal - Non-Adjustable
<b>Limit Switch Feedback</b>	Customizable
<b>Screw Type</b>	ACME Screw
<b>Motor Type</b>	Brushed DC Motor
<b>Connector Type</b>	See Page 5
<b>Wire Length</b>	40" (customizable)
<b>Housing Material</b>	6062 Aluminum Alloy
<b>Rod Material</b>	Stainless Steel
<b>Gear Material</b>	Powder Metallurgy Steel Alloy
<b>Color (Shaft)</b>	Silver
<b>Color (Motor End)</b>	Graphite
<b>Noise</b>	<90dB
<b>Duty Cycle</b>	20% (4 minutes on, 16 minutes off)
<b>Overload Protection</b>	Built-in Electric Shutoff
<b>Operational Temperature</b>	-40°C to 60°C (-40°F to 140°F)
<b>Protection Class</b>	IP66
<b>Feedback Options</b>	Hall Effect or Potentiometer
<b>Certifications</b>	CE/RoHS
<b>Mounting Brackets</b>	BRK-17
<b>Mounting Ends</b>	Customizable



# Dimensions

(Dimensions in inches)

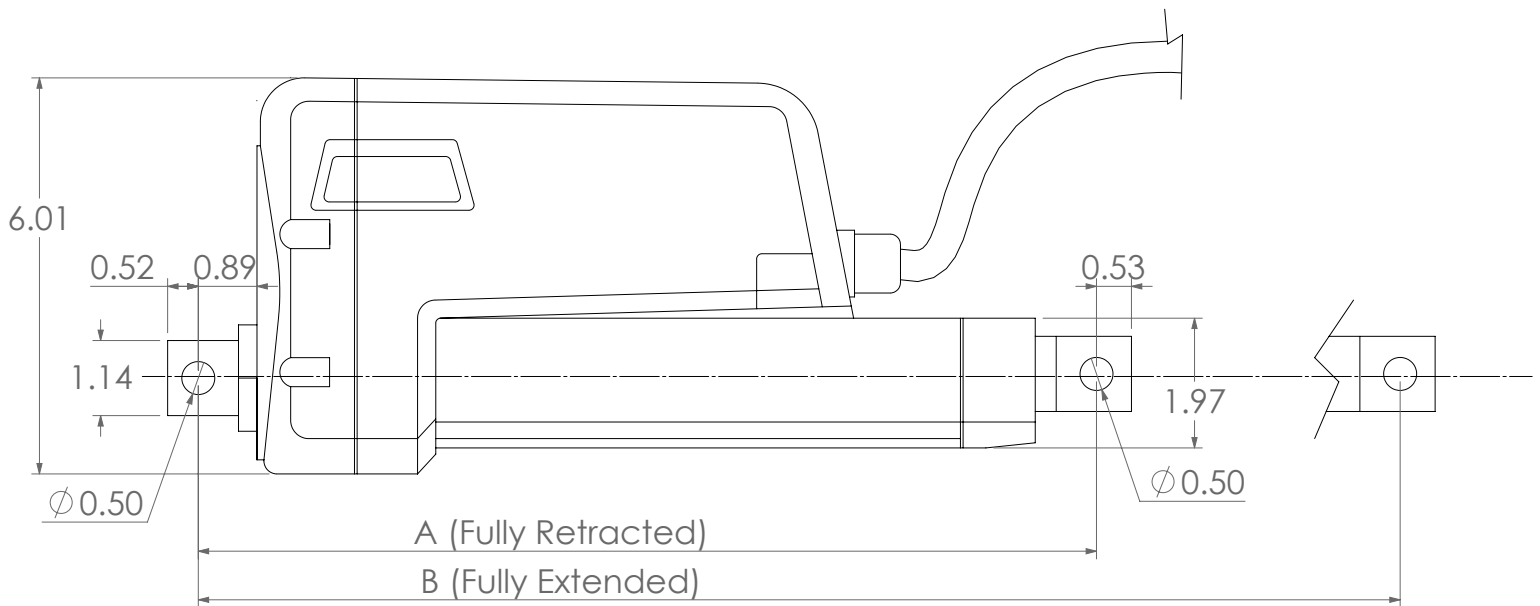
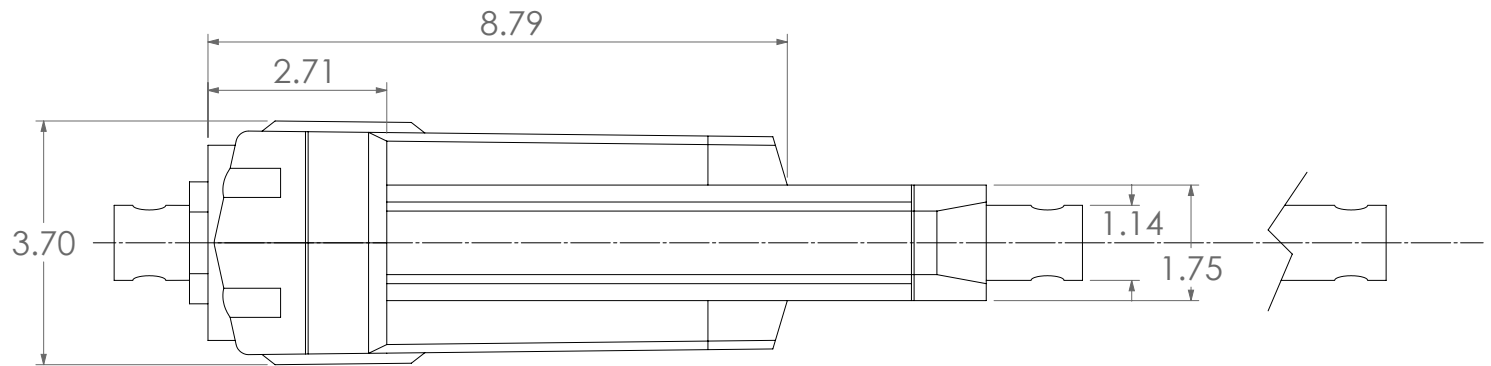

## Hole to Hole

PA-13	Stroke	4	6	8	10	12	14	16	18	24	30	40
	A	11.89	13.86	15.87	17.87	21.85	23.86	25.83	27.83	33.86	41.81	51.81
B	15.91	19.84	23.86	27.87	33.86	37.87	41.81	45.83	57.87	71.81	91.81	

### For Stroke Length Less Than 4"

$$A = 11.89"$$

$$B = \text{Stroke Length} + 11.89"$$

### For Stroke Length 12" and Greater A

$$= \text{Stroke Length} + 9.84"$$

$$B = \text{Stroke Length} \times 2 + 9.84"$$

### For Stroke Length 4" and Greater

$$A = \text{Stroke Length} + 7.87"$$

$$B = \text{Stroke Length} \times 2 + 7.87"$$

### For Stroke Length Greater Than 24"

$$A = \text{Stroke Length} + 11.81"$$

$$B = \text{Stroke Length} \times 2 + 11.81"$$



# Speed vs Load

## Speed vs. Load: PA-13 Linear Actuator

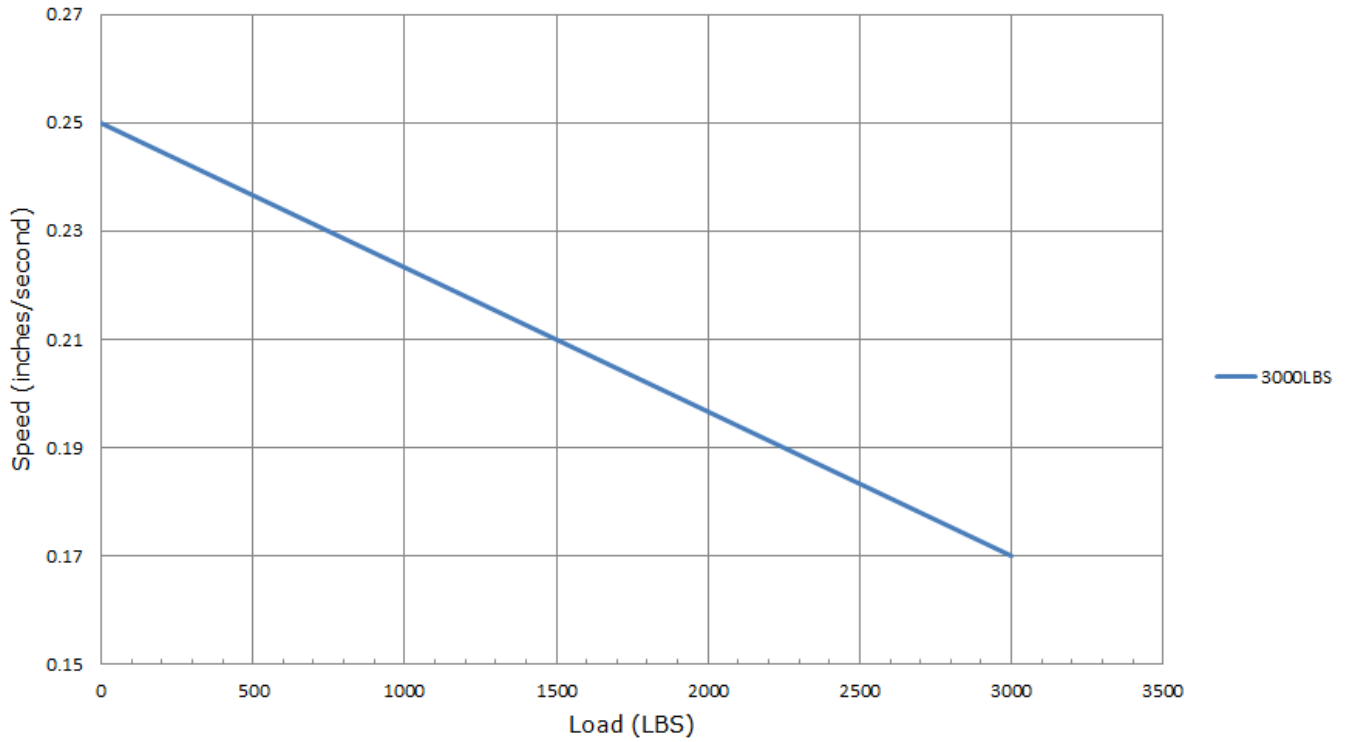

# Current vs Load

## Current vs. Load: PA-13 Linear Actuator

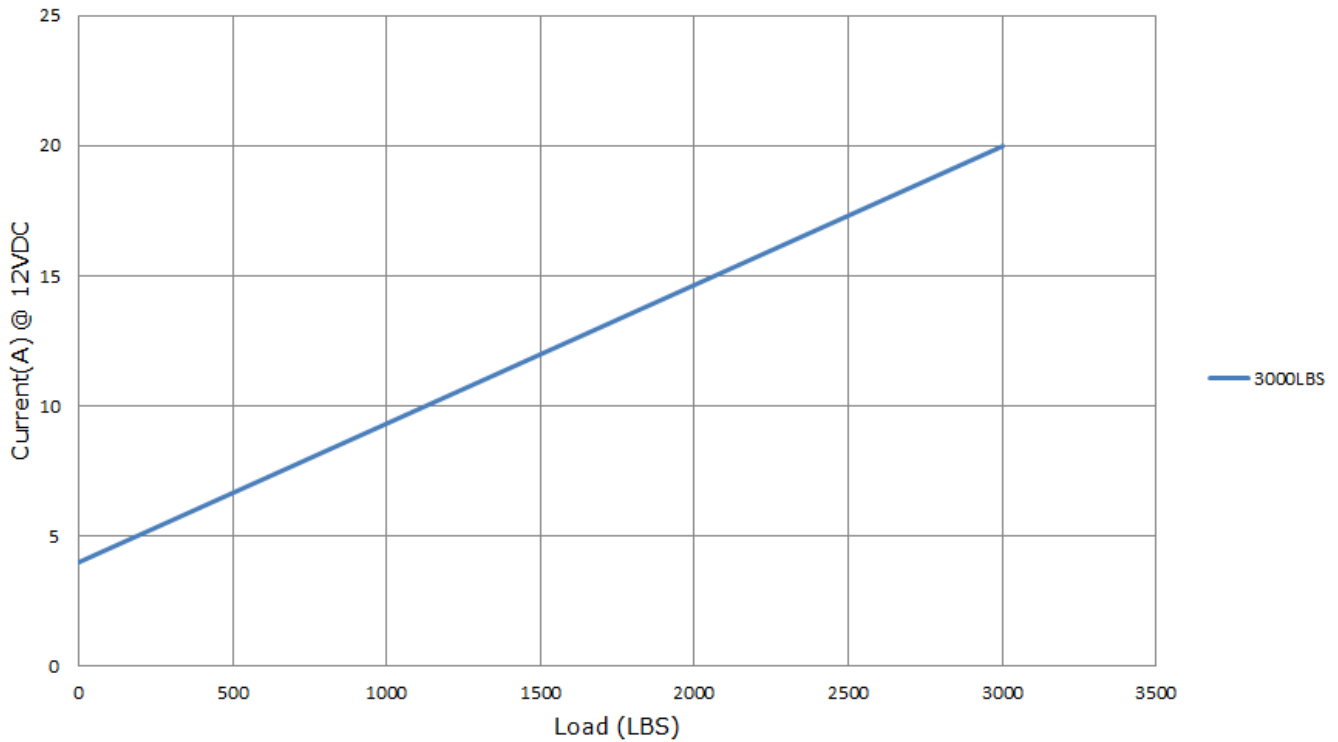



## 2-Pin Connector (Standard)

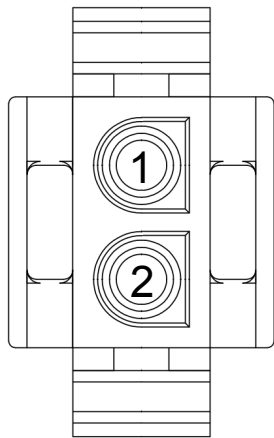

Motor	
1	2
M-	M+

Component	Part Name	Part Number	Mating Part Number
Housing	Tyco Electronics AMP Universal Mate-N-Lok PLUG	1-480698-0	1-480699-0